

Obstacle course for the Camel Road Playground

Made by local people for local people



Pilot making project with young people in St John's Green North Woolwich



Example of an obstacle course in a small park.

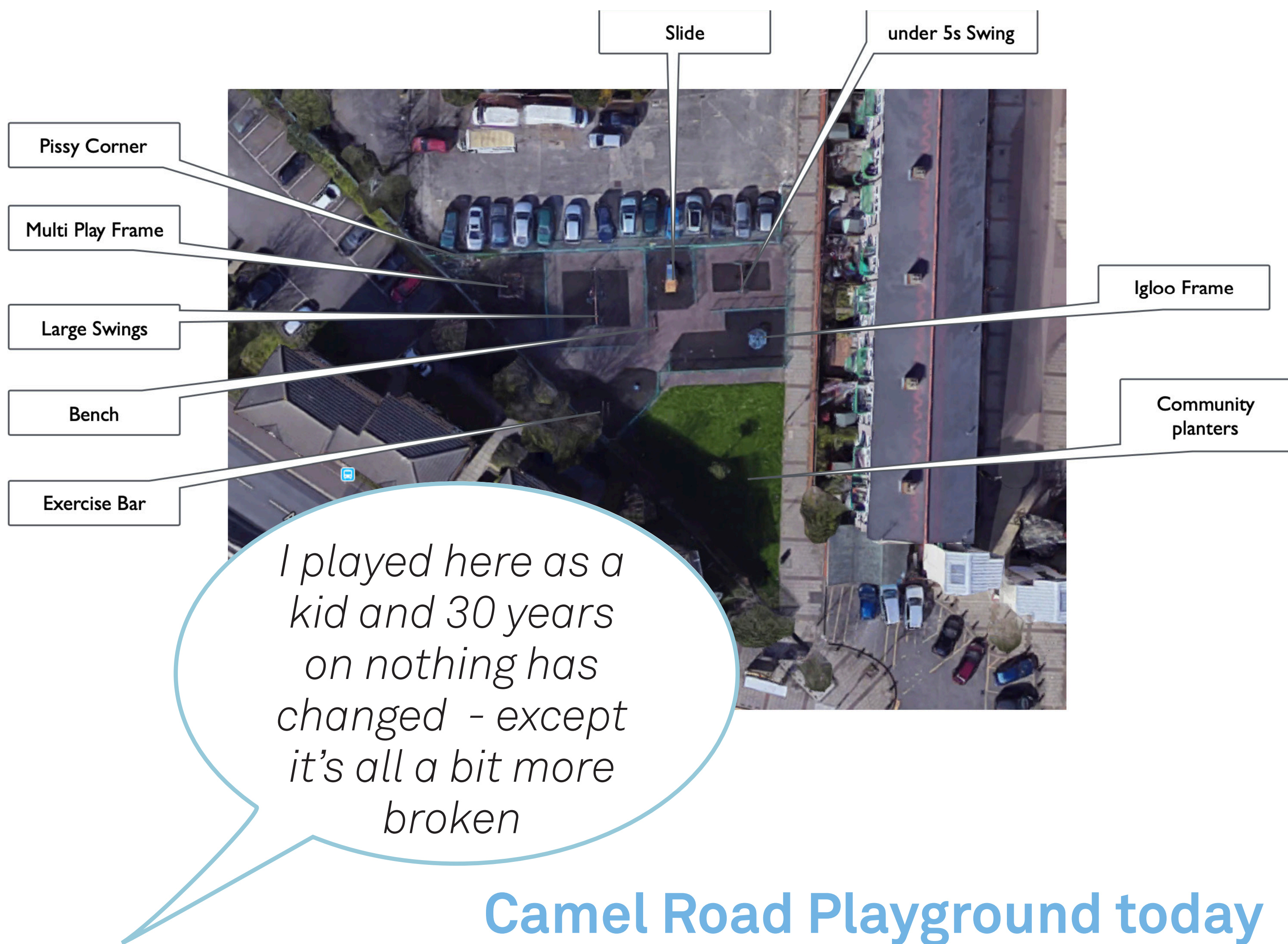

Slide

under 5s Swing

Pissy Corner

Multi Play Frame

Large Swings

Bench

Exercise Bar

Igloo Frame

Community
planters

*I played here as a
kid and 30 years
on nothing has
changed - except
it's all a bit more
broken*

Camel Road Playground today



IMPROVEMENTS TO CAMEL ROAD PLAY SPACES

The two triangular play spaces off Camel Road are in need of upgrading to improve the play offer for young people and younger children and to make a place where adults want to take their children and stay while they play.

At the moment, the west triangle has a play offer for older children with a ball court, climbing walls and seating while the east triangle has some older play equipment for younger children and a grassed area with some planting undertaken by the community.

The aim is to:

- Repair and improve the things that still work.
- Replace and upgrade the things that are broken.
- Make an overall improvement to the play experience.
- Provide places to sit
- Remove some of the fencing to make the space more welcoming
- Provide an opportunity for food growing or other types of community planting.

The drawings on the next page show the initial ideas to improve these spaces.

However, we may not have enough funding to deliver the whole scheme in one go and would like to hear what you think are the priorities for immediate improvement.

You can tell us what you think in the following ways:

Fill in the form below and return post to:
MUF, 72-74 Mare Street, E8 4HT
Or email your answers to us at:
camelroadplayground@gmail.com

Public Workshop
Come and meet us on site on 9th June - we will be doing a testing ideas with a workshop and drawing out designs in full scale.

This will be a drop in event - come anytime between 3 and 6pm

Covid 19
While the event is public, please be aware of the Covid restrictions that are currently in place. The event will be limited to no more than 50 people at any given time.

Camel Road Play Triangles - Community Consultation

muf/Creates/LBN

POTENTIAL IMPROVEMENTS TO THE PLAY AREAS

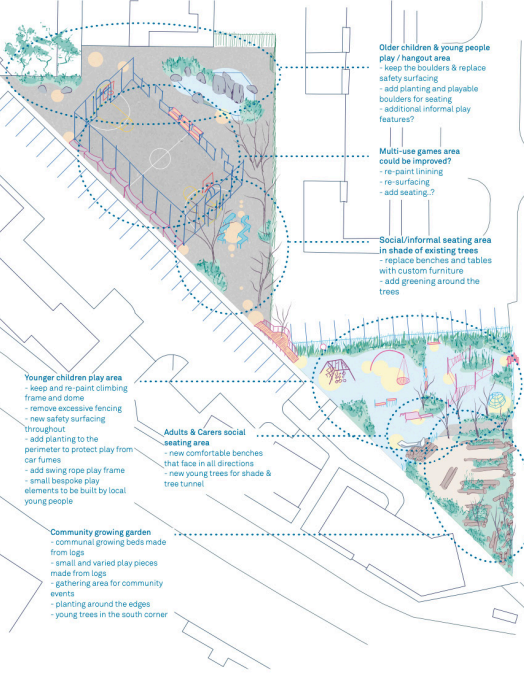

Older children & young people play / hangout area

- keep the boulders & replace safety surfacing
- add planting and playable boulders for seating
- additional informal play features?

Multi-use games area could be improved?

- re-paint training
- re-surfacing
- add seating?

Social/informal seating area in shade of existing trees

- replace benches and tables with custom furniture
- add greening around the trees

Younger children play area

- keep and re-paint climbing frame and dome
- remove excessive fencing
- new safety surfacing throughout
- add planting to the perimeter to protect play from car fumes
- add swing rope play frame
- small bespoke play elements to be built by local young people

Adults & Carers social seating area

- new comfortable benches that face in all directions
- new young trees for shade & tree tunnel

Community growing garden

- communal growing beds made from logs
- small and varied play pieces made from logs
- gathering area for community events
- planting around the edges
- young trees in the south corner







Camel Road Play Triangles - Community Consultation

muf/Creates/LBN

WHAT ARE THE PRIORITIES?

How would you rate them in order from 1 to 10? Put the number in the boxes provided. You can add your own priorities below if you have any other suggestions

- ☐ Repair things that are broken
- ☐ Increase planting to make spaces for wildlife and to help neutralise noise and pollution
- ☐ Plant more trees
- ☐ Make spaces for parents and carers to sit in the sun while young children play
- ☐ Make a place for the community to congregate
- ☐ Make space for children and the community to grow food or other kinds of plants
- ☐ Provide adventurous play for young people
- ☐ Provide adventurous play for younger children
- ☐ Provide places for children to play in nature
- ☐ Link the two spaces together
- ☐ Stop cars parking against the playground fence
- ☐ Make the ball court more welcoming & inclusive



Camel Road Play Triangles - Community Consultation

muf/Creates/LBN

HOW IS THE PROJECT FUNDED AND WHO ARE WE?

How is this project funded?

The funding for the improvements is a grant from the National Lottery Community Fund, which is raised to fund projects and help communities thrive.

The funding was secured by Create London, a charity that finds new ways for art and creative practice to benefit the lives of people in towns and cities. We work with artists, architects, communities, cultural and public institutions and local authorities, developing projects that create lasting and sustainable change. We are part of a growing movement that seeks to expand what art can do and who it is for.

London Borough of Newham as the landowners and are involved in the design discussions.

The funding can only cover the building works and not the cost of looking after the play spaces, which is the responsibility of Newham Council.

Who is running the project?

Create made the funding application and have a working partnership with Newham to deliver the improvements.

The designers for the project are muf architecture art. muf is an internationally recognised practice whose work is a collaboration between art and architecture. muf engage with, and build on, the capacity of local communities to deliver high quality and sustainable outcomes and have been working with the Royal Dock Activity and Learning Centre on improvements to St John's Green and a plan to improve other green spaces throughout North Woolwich and provide play on the way/child friendly routes.

muf will work with an organisation called Volunteer if Yourself to build parts of the playground as skill sharing workshops to give local young people work experience

WHAT MUF & CREATE HAVE BEEN DOING IN ST JOHN'S GREEN



The brief to make improvements to St John's Green was established through a series of workshops with local groups who wanted new places for gathering, play, outdoor cooking and to increase the biodiversity of the green.

New Places for gathering, cooking and play.

A design workshop with a group of under 16s. Mo the park allotment gardener and Rita, vendor of the community cafe established a design for seating, a stage and an outdoor oven.

The young people, then built the furniture, learning a combination of fundamental building techniques as well as specialist finishing Shou Sug Ben.

Biodiversity Audit

To measure the success of the project over time we established a biodiversity baseline audit of the green's existing habitat with the local community.

Across 3 days we studied the habitat around ROLAC with groups of under 10s, under 16s, Tate & Lyle factory workers and ROLAC's Bingo Club with all data on species and frequency recorded.

Camel Road Play Triangles - Community Consultation

muf/Creates/LBN



WHILE WE'RE HERE...

We'd love to hear how else you think we could help to improve the wider neighbourhood's play and green spaces.

- Where would you most like to see improvement next?
- How can the local area be made greener and more enjoyable to live in?
- How can the area be made safer and more friendly to children?
- How should residents and the local community be involved in future projects?

Please feel free to also include answers to these separately or in the section below...

Camel Road Play Triangles - Community Consultation

muf/Creates/LBN

share your knowledge, what matters most to you?

Invitation to local people to co-design improvements to the playground



Some of the things people want

I come here because I live in a one bed-room flat, there's five of us, this is like an outside room for me.....I'd like a covered area to sit.

Have drums or a punch bag to get rid of anger

Create jobs to make activities for kids, vandalism happens because the kids are bored.

I'm 8, there's stuff for little kids and teen-agers but nothing for us

The fence broke and nobody repaired it.

somewhere to grow fruit and vegetables, I don't have enough space at home

Trampolines, a ping-pong table, space to ride a bike with no cars, a tree house, an obstacle course

The improvement plan

We have raised £80,000 from
Big Lottery + other funding sources
£5,000 from the Assembly will fund
local children and young people to build
an obstacle course in the park with
Volunteer it Yourself

OBSTACLE
COURSE

POSSIBLE
SWING

POSSIBLE
SWING

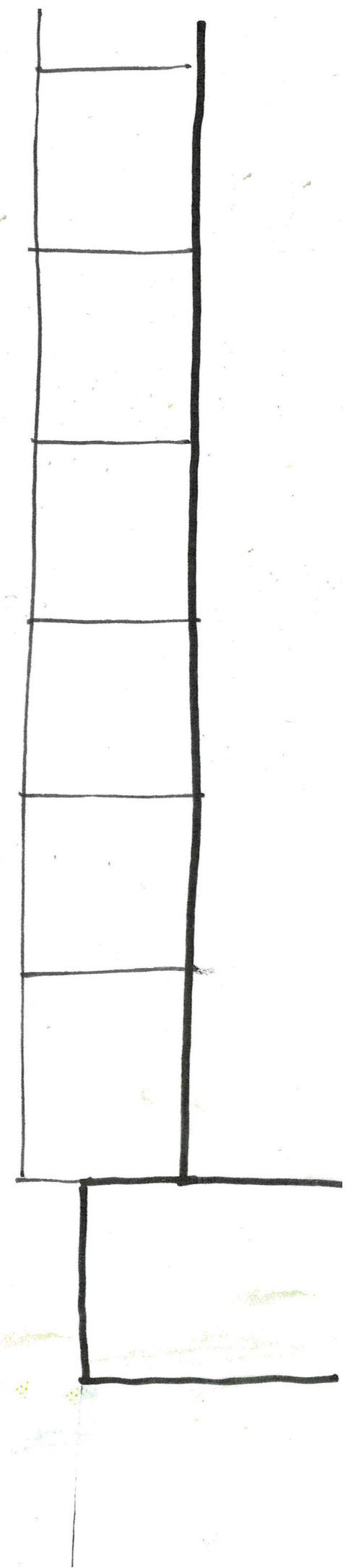

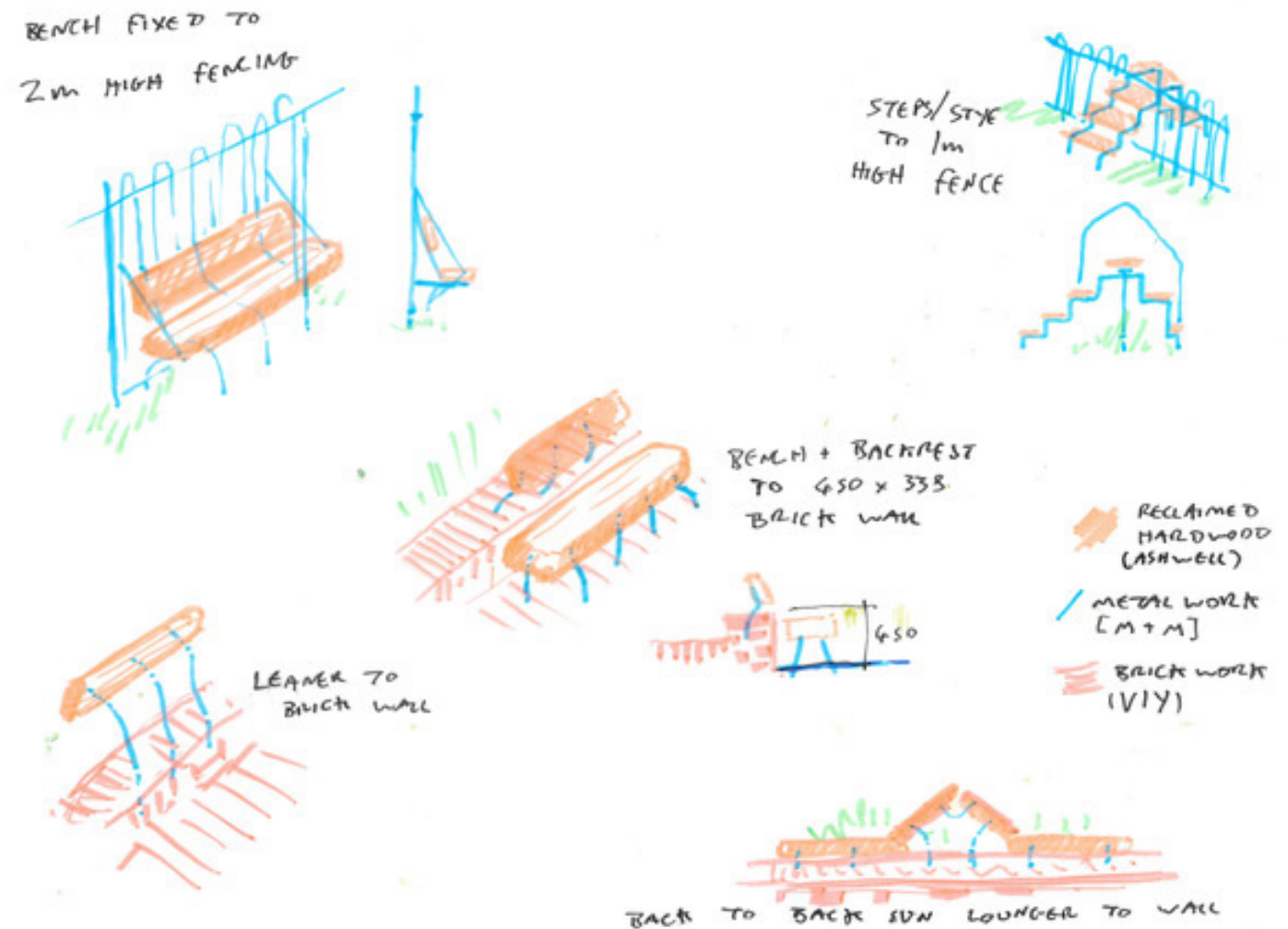

Volunteer it Yourself will help local young people to build their own playground.

We have already made furniture in St John's Green and want to continue this skill sharing

